



3-D Solutions Design Service presents

The POWER CATALOG and POWER TEMPLATE System for Tooling Design

FOR MORE INFORMATION PHONE (616) 863-8630

WWW.3DDIEDESIGN.COM

The *Power Catalog and Power Template System* provides a proven method to design tooling with CATIA V5.

We offer a complete design solution including *Power Catalog* components, *Power Template System*, recommended file structure, tree structure, manuals, documentation, and training on "best practices."

Who benefits from our product

The *Power Catalog and Power Template System* is recommended for companies designing and building all kinds of metal stamping tools including: progressive, line, and transfer dies, as well as special machines and prototype tooling. It is a very effective way for metal stamping facilities to get uniform products from all their tooling sources both domestically and globally. We also create customized catalogs and templates to match specific standards for any stamping facility. Custom catalogs and templates can then be utilized by the stamping facilities' tooling sources. This eliminates much of the tool review time required by metal stamping companies.

Concept to completion
in days rather than weeks

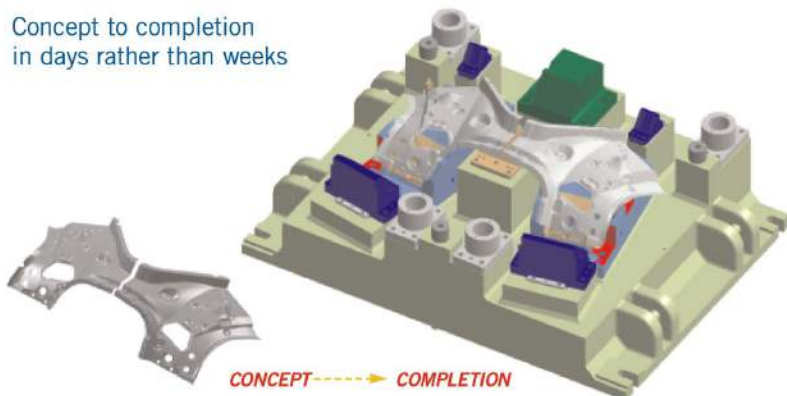

A proven system, not a new idea

This product was developed by tooling designers for tooling designers. At 3-D SOLUTIONS DESIGN SERVICE our on-staff design team has been using and refining this system for over nine years. Our company designs tooling for numerous customers throughout North America. Tooling shops and design houses currently using the *Power Catalog and Power Templates System* can testify to their success since implementing the *Power Catalog and Power Templates System*.

"We hit the floor running. We have been able to concentrate on designing instead of spending 1+ years creating our own catalog. We are 100% satisfied with the Power Catalog and Power Templates System."

Mike Brower
Enterprise Tool & Die Inc.

From the most complex progressive dies to large multi-station transfers, the *Power Catalog and Power Template System* will supply your tooling needs

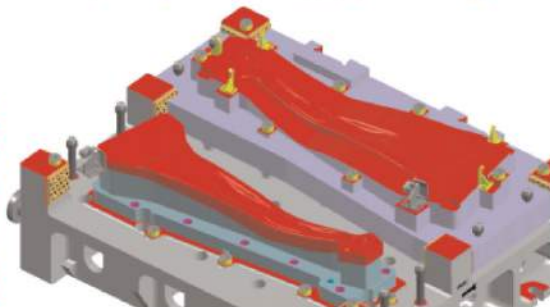
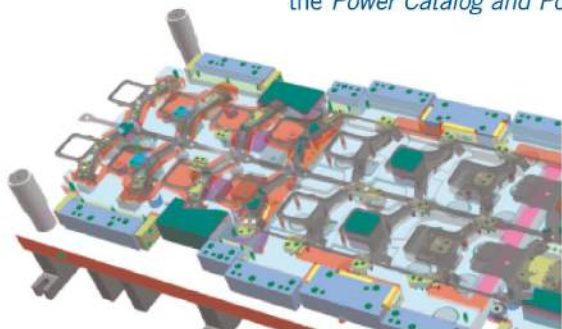

THE *POWER TEMPLATE* SYSTEM

Die Set Templates

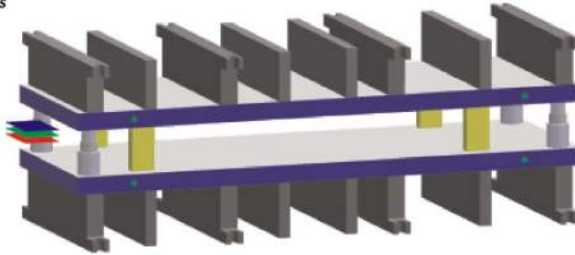

Strip or Part Templates can be inserted into Die Set or Casting Templates to quickly start a project.



Casting Templates

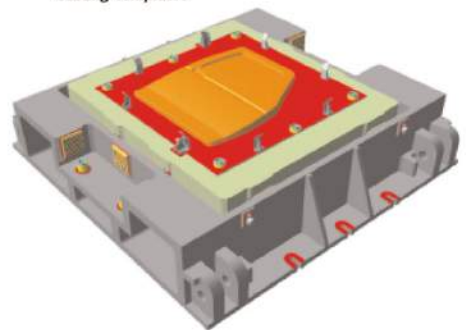

Casting Templates

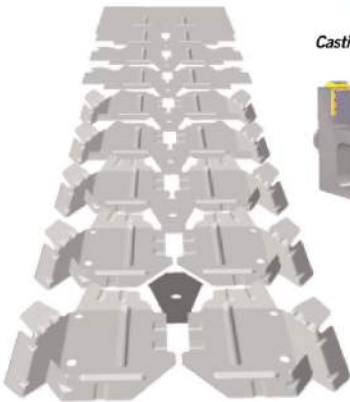

Stock Strip Templates

The Power Template System includes

- Die Set Template
- Lifter Rack Template
- Stock Strip Template
- Nitrogen Manifold Template
- Nitrogen Plumb Plate Template

Various Casting Templates available separately. Ask your sales representative for additional information.

Here is what some of our customers say about the *Power Catalog and Power Template System*

“Power Catalog and Power Templates have been a big time saver in designing our tools. It is very customizable and fits our own specific needs — that is a very big plus. Another great bonus is the help support we have received. We have been using it for 1 1/2 years and attest that it is very user-friendly.”

*Bill Conner
Die-Matic Tool and Die, Inc.*

“CATIA V5 design efficiencies have been tremendously improved using the Power Catalog and Templates. The power of the Catalog functionality makes designing more productive. Novice CATIA V5 designers are empowered by its functionality, and can develop new designs within days.”

*Bob Heffelbower
Trimline Tool, Inc.*

“We bought the Power Catalog and Power Templates and immediately began designing efficiently with CATIA V5. We would have spent months building everything in between jobs.”

*Kevin Schumaker
Competition Engineering, Inc.*

Additional templates and components may be added to complete your design. Once your job is completed, generate 2-D prints quickly and easily. All templates come with 2-D prints linked to the 3-D design. Simply open the drawings and update the views to see your finished project in 2-D.

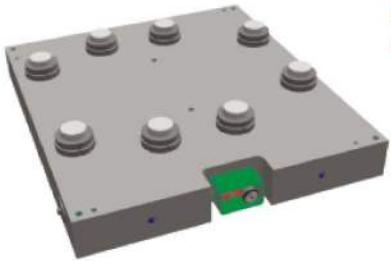

**Nitro Plumb Plate Template
and Manifold Template**

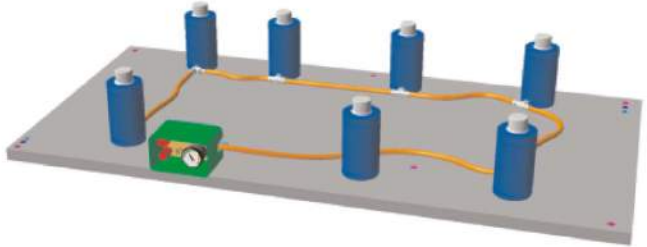

THE **POWER CATALOG** COMPONENT SYSTEM

The *Power Catalog* reduces design time by utilizing thousands of pre-drawn intelligent components. Eliminate wasted time downloading simple solids from vendor websites. The *Power Catalog* components not only give you the desired component, but also carry the necessary machine bodies required for machining pockets, clearance holes, fasteners, dowels and more. All components carry the necessary information for ordering and are directly linked to the stock list. This information continually updates as you make adjustments to the components, and virtually eliminates stock list errors.

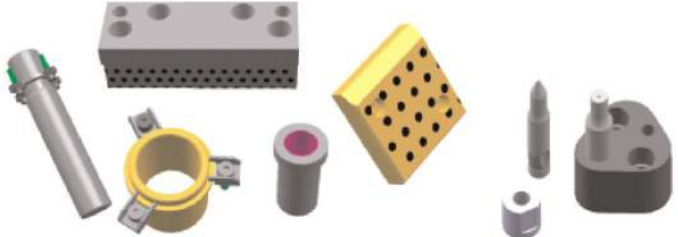

Jolico, IEM, Lamina Components

Dayton Components

Choose components from Dayton, IEM, Lamina, Dadco, Standfast, Jolico, Misumi, and many more. We are updated regularly by vendors to ensure the most up-to-date catalog components.



Misumi and Sankyo Components

The *Power Catalog* contains more than purchasable components. There is an extensive selection of "made components" ready for insertion into the design assembly. Some examples include: Trim Steels, Punch Steels, Stock Guides, Stripper Pads, Pad Windows, Form Blocks, Pitch Swivels, Cam Components, Keys, Keepers and many more.

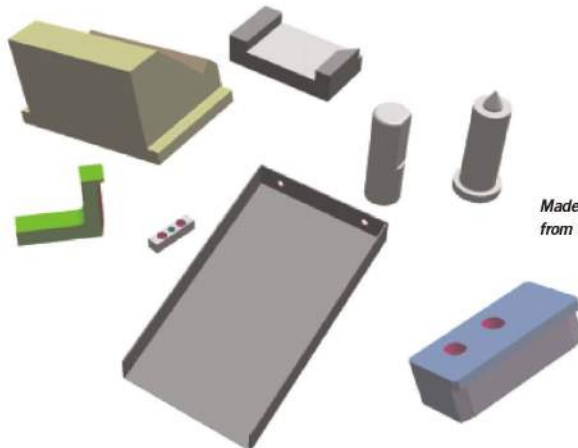

**Made components
from the Power Catalog**

COMPLEX PRODUCTS ARE EASILY DESIGNED USING OUR TEMPLATES AND CATALOGS



Transmission Cross-member



Floor Pan extension



Shields and brackets

Eliminate the learning curve

Our customers effectively design tooling immediately after implementing the *Power Catalog and Power Templates System*. After basic training on CATIA V5, designers receive an additional two days training using the *Power Catalog and Power Templates System*. Designers insert components into the design, rather than drawing each component from scratch. There is no need to become an expert using CATIA V5.

Additional benefits of our System

By leveraging the constantly expanding network of *Power Catalog and Power Templates System* users, companies develop additional resources to outsource design, machining, or entire projects. With everyone in the network utilizing the same system, there is a seamless flow of information from one company to another. Outsourced designs look as if they came from your engineering department. These designs flow seamlessly through the down-stream manufacturing process without modification and interpretation from internal staff.

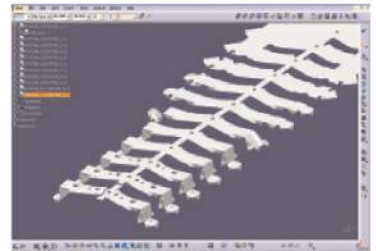

Complex strip layout using our template

How does your company plan to handle increasingly shorter deadlines?

Join our network of *Power Catalog and Power Templates System* users: call (616) 696-9344

POWER CATALOG

Thousands of SMART
3-D Modeled Components.

POWER TEMPLATES

CATIA V5 Based Smart
Assemblies — Fast and Easy
to Use

Tooling Design Package Includes:

- Power Catalog (CD)
- Power Templates (CD)
- Training Manual and Documentation
- 2 Days On-site Training

Technical Support also available

TO ORDER CALL
(616) 863-8630



**3-D SOLUTIONS
DESIGN SERVICE**

598 BYRNE INDUSTRIAL DR.
ROCKFORD, MI USA 49341

WWW.3DDIEDESIGN.COM